

PLAN 1

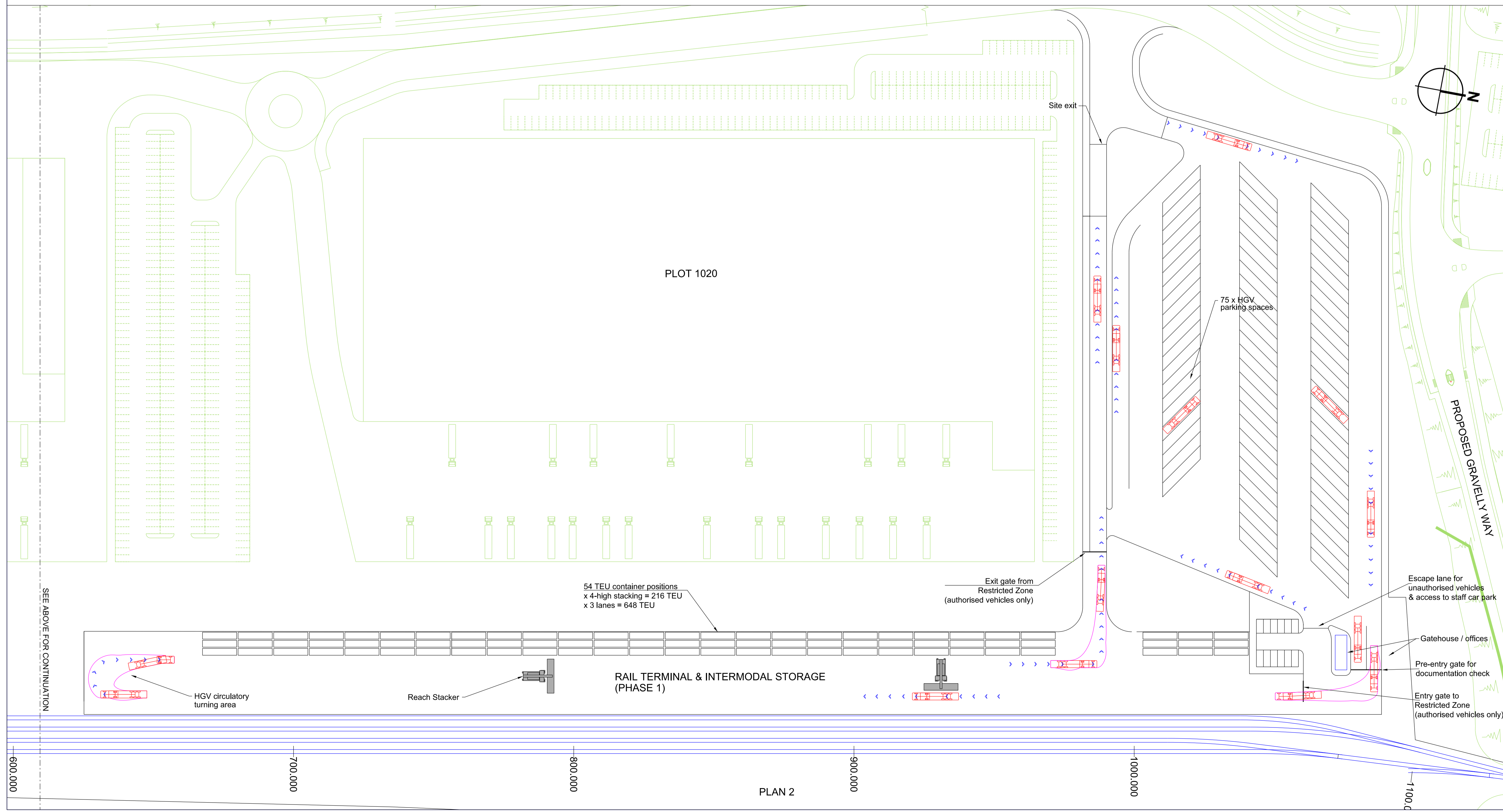

PLAN 2

1. This drawing is to be read in conjunction with all other relevant drawings and specifications. See Document 2.14 for Railway General Arrangement, Document 2.16C for Railway Longitudinal Sections and Document 2.15A & B for Railway Cross Sections.
2. This drawing is based on the Ordnance Survey Data issued by Chetwoods licence no. 100031961 and verified with 1m ea LIDAR height data licence no. 70920949. All design information is subject to confirmation by rail corridor topographic survey.
3. Site datum (design datum) chainage of 0m is set at point of switch of proposed connection turnout on Down Penkridge main line at approximately 19m 1580yds and increasing with the track mileage.
4. Proposed track works and specific alignments are subject to detailed design.

- PROPOSED ILLUSTRATIVE MASTERPLAN
- EXISTING MAIN LINE RAIL TRACK CENTRELINES
- PROPOSED RAIL TRACKS (PHASE 1)
- TEU TWENTY-FOOT EQUIVALENT UNIT SHIPPING CONTAINER

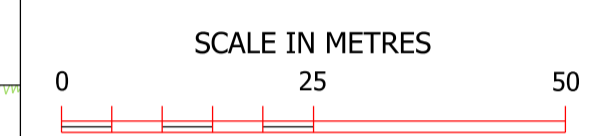

DRAFT

Revisions

West Midlands Interchange

Project
THE WEST MIDLANDS RAIL FREIGHT INTERCHANGE ORDER 201X

Drawing Status
DRAFT STAGE 2 CONSULTATION

Drawing Title
RAIL TERMINAL - ILLUSTRATIVE PHASE 1 LAYOUT

Drawing Size A1

Regulation	Document
5 (2) (0)	2.15A

Drawn AT	Date 21/03/17	Scale 1:750 (A1)	Reviewed NG
Drawing No.	IMT D5.10	Rev.	A